

# **xiaomi** Xiaomi Robot Vacuum X10+ Brush Replacement Instructions

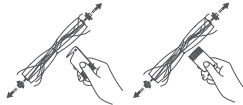

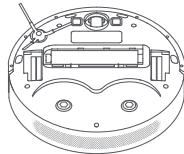
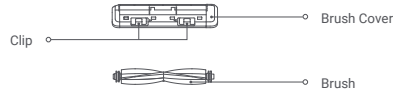

## Replacement Instructions

---

1. Flip the robot vacuum over and pinch the clips to remove the brush cover.
2. Remove the used brush and install the new one. Then reinstall the brush cover, and make sure it is secured in place.

### Notes:

- It is recommended to replace the brush every 6–12 months for an optimal cleaning effect.
- For cleaning, use the included cleaning tool to cut the hair tangled on the brush and remove any foreign objects.

## WARRANTY NOTICE

As a Xiaomi consumer, you benefit under certain conditions from additional warranties. Xiaomi offers specific consumer warranty benefits which are in addition to, and not instead of, any legal warranties provided by your national consumer law. The duration and conditions related to the legal warranties are provided by respective local laws. For more information about the consumer warranty benefits, please refer to Xiaomi's official website <https://www.mi.com/en/service/warranty/>. Except as prohibited by laws or otherwise promised by Xiaomi, the after-sales services shall be limited to the country or region of the original purchase. Under the consumer warranty, to the fullest extent permitted by law, Xiaomi will, at its discretion, repair, replace or refund your product. Normal wear and tear, force majeure, abuse or damage caused by the user's negligence or fault are not warranted. The contact person for the after-sale service may be any person in Xiaomi's authorized service network, Xiaomi's authorized distributors or the final vendor who sold the products to you. If in doubt please contact the relevant person as Xiaomi may identify.

The present warranties do not apply in Hong Kong and Taiwan.

Products which were not duly imported and/or were not duly manufactured by Xiaomi and/or were not duly acquired from Xiaomi or a Xiaomi's official seller are not covered by the present warranties. As per applicable law you may benefit from warranties from the non-official retailer who sold the product. Therefore, Xiaomi invites you to contact the retailer from whom you purchased the product.

Manufactured for: Xiaomi Communications Co., Ltd.

Manufactured by: Dreame (Tianjin) Information Technology Co., Ltd.

(a Mi Ecosystem company)

Address: Room 2112-1-1, South District, Finance and Trade Center, No.6975

Yazhou Road, Dongjiang Bonded Port Area, Tianjin Pilot Free Trade  
Zone, Tianjin, China

For further information, please go to [www.mi.com](http://www.mi.com)

Made in China

Importer:

Beryko s.r.o.

Pod Vinicemi 931/2, 301 00 Plzeň

[www.beryko.cz](http://www.beryko.cz)

